

N

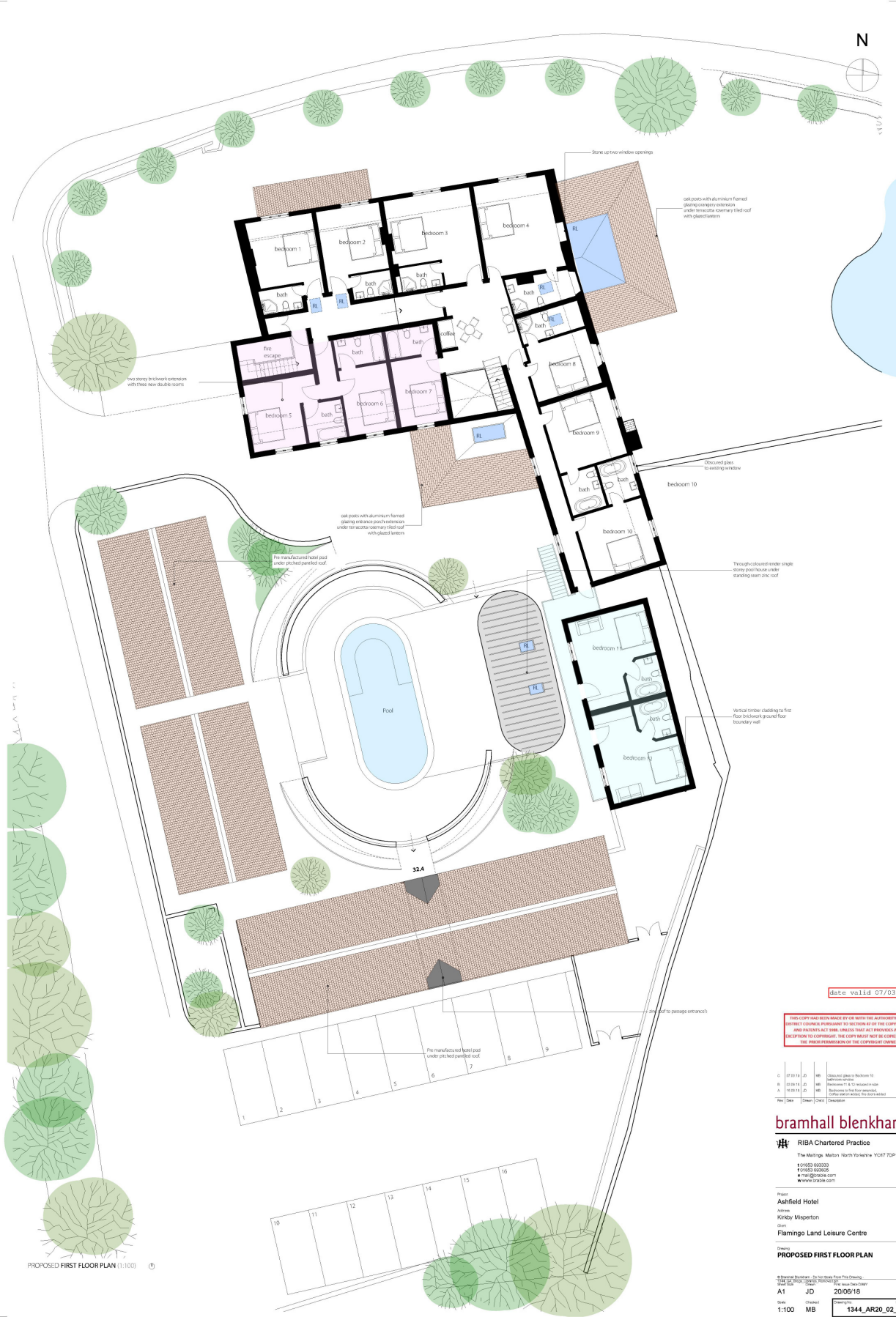
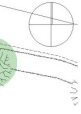

PROPOSED FIRST FLOOR PLAN (1:100)

date valid 07/03/2019

THIS COPY HAS BEEN MADE BY OR WITH THE AUTHORITY OF BRAMHALL BLENKHARN DIRECTLY FROM THE ORIGINAL TO WHICH ALL OF THE COPYRIGHT RIGHTS AND PATENT RIGHTS ARE RESERVED. THIS COPY SHALL NOT BE COPIED WITHOUT THE WRITTEN PERMISSION OF THE COPYRIGHT OWNER.

C	07.03.19	JD	MB	Obscured glass to Bedroom 10
R	05.03.19	JD	MB	Bedrooms 7 & 10 canopy extension
A	19.03.19	JD	MB	Bedrooms 7 & 10 canopy extension
Rev	Date	Drawn	Checked	Description

bramhall blenkarn

RIBA Chartered Practice
The Maltings, Malton, North Yorkshire YO17 7DP
01534 803333
01534 803025
info@brambhall.com
www.bramhall.com

Project: Ashfield Hotel
Address: Kirkby Misperton
Client: Flamingo Land Leisure Centre

PROPOSED FIRST FLOOR PLAN

© Bramhall Blenkarn. Do Not Re-use This Drawing.
This Drawing is the Property of Bramhall Blenkarn.
Date: 07.03.19
Author: JD
Check: MB
Scale: 1:100
Drawing No: 1344_AR20_02_C